



VISTA

1 1 24

Open Plan, Kitchen and Lux Bathroom

Immerse yourself in the pinnacle of luxurious living with **Vista**. This contemporary and roomy tiny home showcases floor-to-ceiling glass windows, flooding the space with an abundance of invigorating natural light.

Key Features

- Strong thermally insulated walls and roofs
- Australian Compliant electrical
- Optional Air Conditioner, Cladding and Base Trailer
- Fast on-site assembly
- Double glazed insulated windows and doors
- 3 Year Warranty*
*Terms & conditions apply
- Bathroom with luxuriously oversized shower
- Engineered quartz stone benchtop kitchen

VISTA | Open Plan, Kitchen and Lux Bathroom

1  1  24 

Closed Length 5.9m
Closed Width 2.3m

Open Length 5.9m
Open Width 3.9m

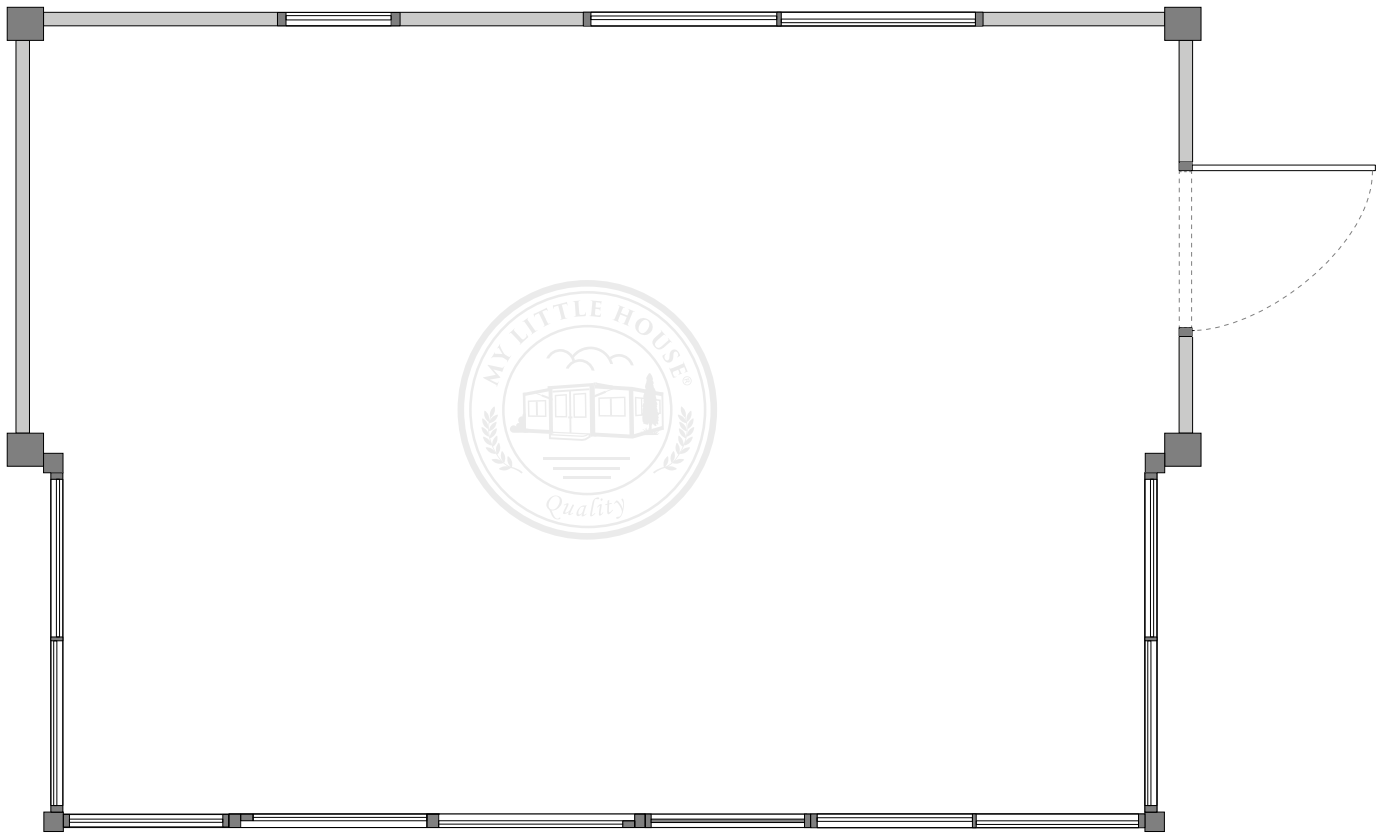

Specifications

FRAME

- Steel frame, zinc rich primer undercoat finished with an epoxy paint in Grand Grey.

FLOOR

- Magnesium concrete composite or high density PVC flooring (model dependant), both offer high performance with little to no maintenance, rot and insect resistant and with great thermal properties.

ROOFS

- Centre section is steel clad and thermally insulated with glass-wool.
- Side roofs are steel or fibreglass clad to the exterior and steel inside with thermally insulated expanded polystyrene.

WALLS

- Thermally insulated with expanded polystyrene and clad with steel to both the inside and exterior.

WINDOWS & DOORS

- Windows are aluminium framed double glazed thermally insulated using toughened glass panels with flyscreens where applicable.
- External doors are aluminium framed double glazed insulated using toughened glass panels.
- Internal doors to bathrooms are aluminium framed and finished with frosted privacy glass.

ELECTRICAL

- EDB (Electrical Distribution Board) installed and wired ready for air conditioning.
- Pre-wired switches and power points (most pre-installed where possible, model specific).
- Pre-wired light cables and supplied with quality low power use L.E.D lights.
- Mains power connection wire, ready for your licenced electrician to connect.

BATHROOM

- Luxurious full length shower with semi-frameless glass screen.
- Basin with chrome tapware and pop up waste.
- Wall cabinet with polished mirror and hanging rail.

KITCHEN

- Glamorous L shape kitchen with white quartz engineered stone bench top and rear mini splash riser, white cabinets and overhead cupboards to one side.
- Stainless steel double bowl sink with ceramic cartridge flick mixer tapware.
- Packaged pre-assembled for quick and seamless installation.

